

Executive Committee Report

30th May 2024

PENDLE RISE SHOPPING CENTRE ACQUISITION

APPENDIX TWO – PRSC PROPOSALS

OVERVIEW OF PROPOSALS

- A planning approval **23/0268/FUL** was received on 11 September 2023 for the replacement shopping centre and demolition of the existing scheme. The approval is free from judicial review now the 6-week challenge period has expired.

Figure 1: Planning Boundary

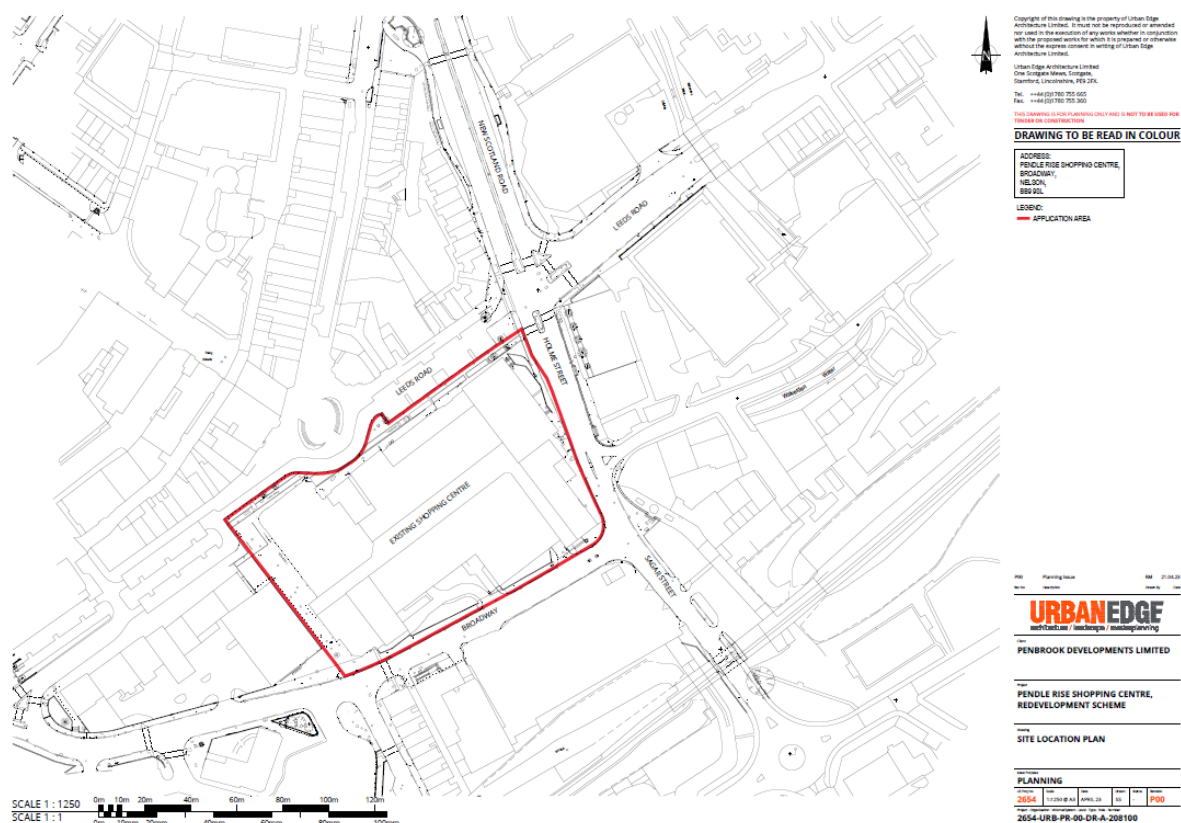

- The replacement scheme will extend to circa 55,000 sqft of ground floor space with potential for mezzanines, arranged in two terraces either side of a centre car park providing circa 140 car spaces. Boots, Greggs, Specsavers, and Card Warehouse all existing tenants within the shopping centre have expressed a desire to be relocated within the new scheme. Costa have also confirmed that they wish to return after they moved out of the existing scheme.

- The retail agents have also identified interest from B&M, Food Warehouse and The Range, but all would be predicated upon a food anchor committing to site.

Figure 2: Proposed Layout

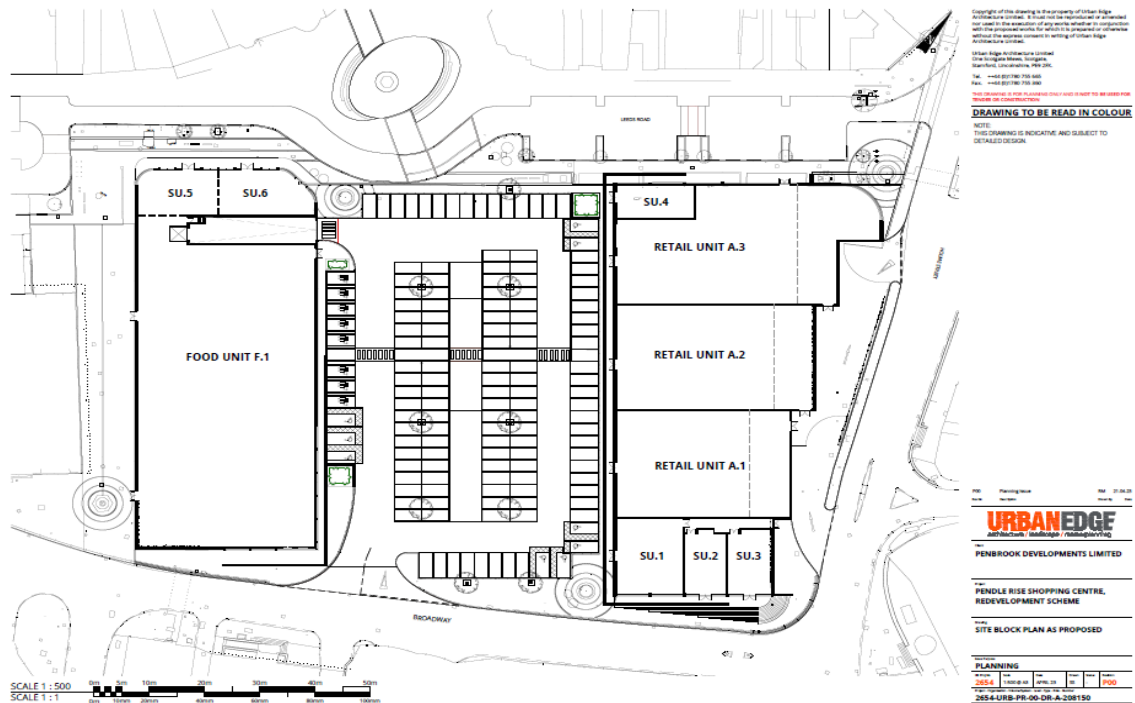

- The following images are extracted from the Planning Design and Access Statement and the plans show the redline planning application boundary along with the overall scheme layout.

Figure 3: Artists impression of how the scheme may look



Figure 4: Artists impression of western elevation

