

**KEY:**

- Stone flag paving, 75mm thick, random length x 600mm wide, 'Whitworth' range, on bedding mortar system to BS 7533, 25mm depth and AC 20 Dense Bin 100/150mm, 45mm depth
- Stone flag channel, 75mm thick, random length x 200mm wide, 'Whitworth' range, on bedding mortar system to BS 7533, 25mm depth and AC 20 Dense Bin 100/150mm, 45mm depth
- Granite tactile blister paving, 80mm thick, 450 x 450mm, Crystal Black coloured, Magma Flamed range on bedding mortar paving system to BS 7533, 25mm depth and AC 20 Dense Bin 100/150mm, 45mm depth
- 150 x 300mm, 900mm long bullnosed "Figueiredo" natural granite kerbs, flamed to front and top faces
- BN Bullnosed "Figueiredo" natural granite kerb (as above)
- DL1 "Figueiredo" natural granite kerb (as above)
- DR1 "Figueiredo" natural granite kerb (as above)
- 230 x 75mm PCC dished drainage channel
- M100K Heelguard Grate drainage channel
- Highway adoption boundary

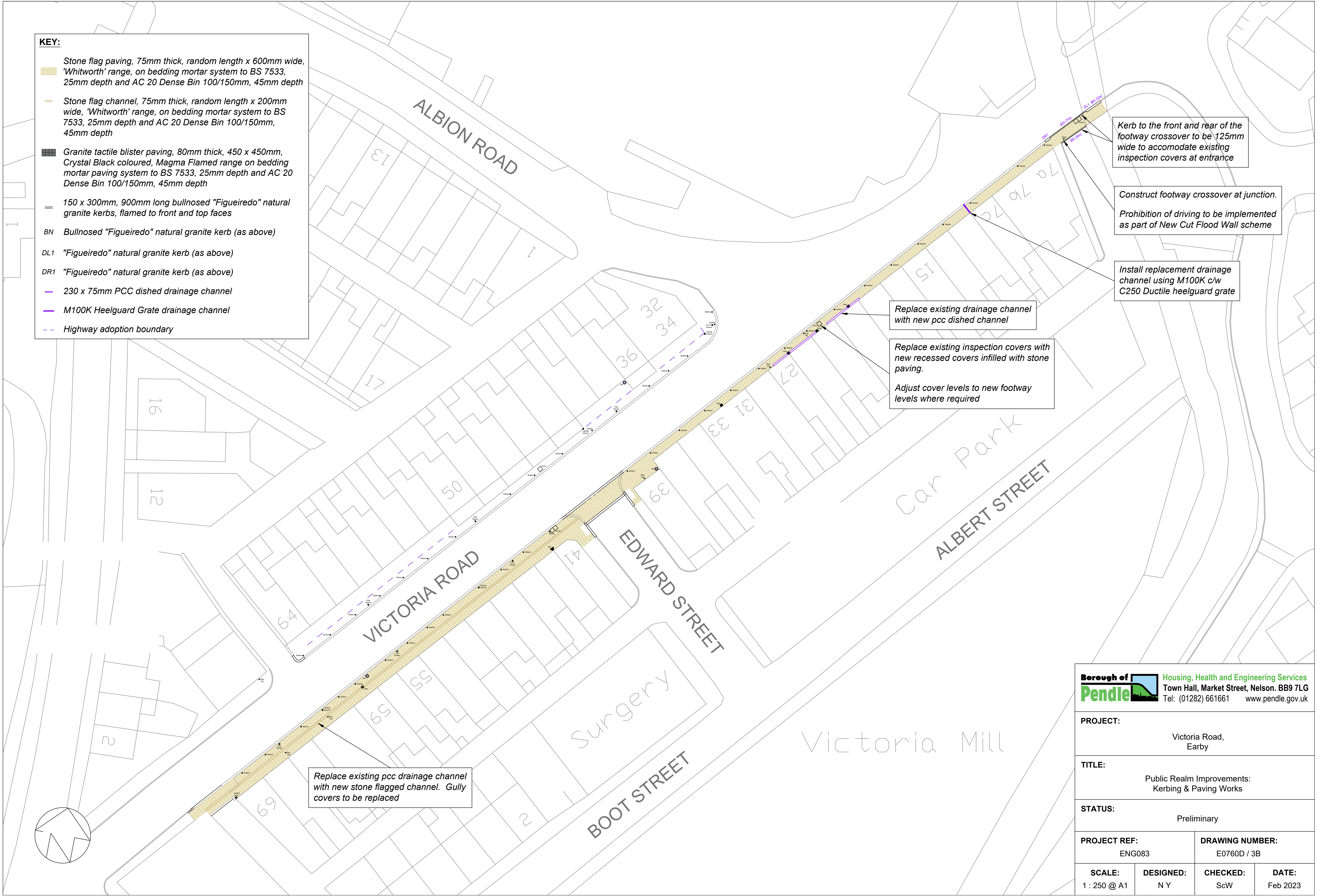

PROJECT: Victoria Road, Earby			
TITLE: Public Realm Improvements: Kerbing & Paving Works			
STATUS: Preliminary			
PROJECT REF: ENG083		DRAWING NUMBER: E0760D / 3B	
SCALE: 1 : 250 @ A1	DESIGNED: N Y	CHECKED: ScW	DATE: Feb 2023