

ALL EXTERNAL MATERIALS MUST BE TO TOTAL SATISFACTION OF LOCAL AUTHORITY PLANNING DEPARTMENT.

ALL WORKMANSHIP & MATERIALS TO COMPLY WITH BUILDING REGULATIONS, BRITISH STANDARDS, CODES OF PRACTICE & N.H.B.C REQUIREMENTS. ALL MATERIALS TO BE FIXED, APPLIED OR MIXED IN ACCORDANCE WITH MANUFACTURERS INSTRUCTIONS OR SPECIFICATIONS.

ALL WORK TO BE CARRIED OUT IN STRICT ACCORDANCE WITH ALL APPROPRIATE HEALTH AND SAFETY LEGISLATION AND WITH DUE REGARD TO ALL RELEVANT RISK ASSESSMENTS, METHOD STATEMENTS, HEALTH AND SAFETY PLANS AND HSE GUIDANCE NOTES AND CODES OF PRACTISE.

WITH
39-6 2004 -
TED; FITTINGS
& LIGHT
CTIONS.

AIR CHANGES PER
T WEATHERTIGHT
OR SIMILAR
JM 20MIN. OVERUN
EN-SUITE. KITCHEN
WHICH CASE 30
FAN TO GIVE 30

SECOND
UTILATION

10N OR 100mm
32mm
SV. TRAPPED
BATH AND

10N TO BE

WITH BS. 5572

SECTION TO BE

LEVEL OF

FINISH

CLOSER & ✓

TH RUNNING

150mm

100mm

988
E # ROOMS

TO EACH

FINISH WITH
ADVISED BY
NOTIONS AND

KEY

IN THE

NOTICELY MARKED
" IN WHITE
BLUE

DOORS SHOULD BE
" FIRE DOOR

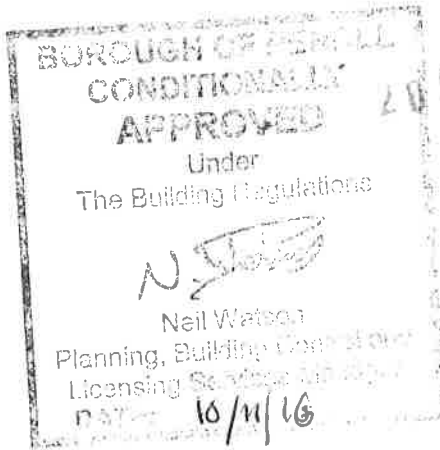

Revisions

Project: PROPOSED ALTERATIONS TO FORM SHOP &
SELF CONTAINED FLAT AT,
10 SKIPTON ROAD, BARNOLDSWICK

Drawing:
working drawing

Client:
MR. D. SULLEY

adm design

Brook Lea, Colne Road, Sough, Barnoldswick, Lancashire. BB18 6TD.
Tel: 01282 853335 - Mobile: 07931 557214 - Email: adm@btconnect.com

Scale(s) 1:50 & 1:100 Date OCTOBER 2016

Drawing no. ADM/16/10/05 Rev.

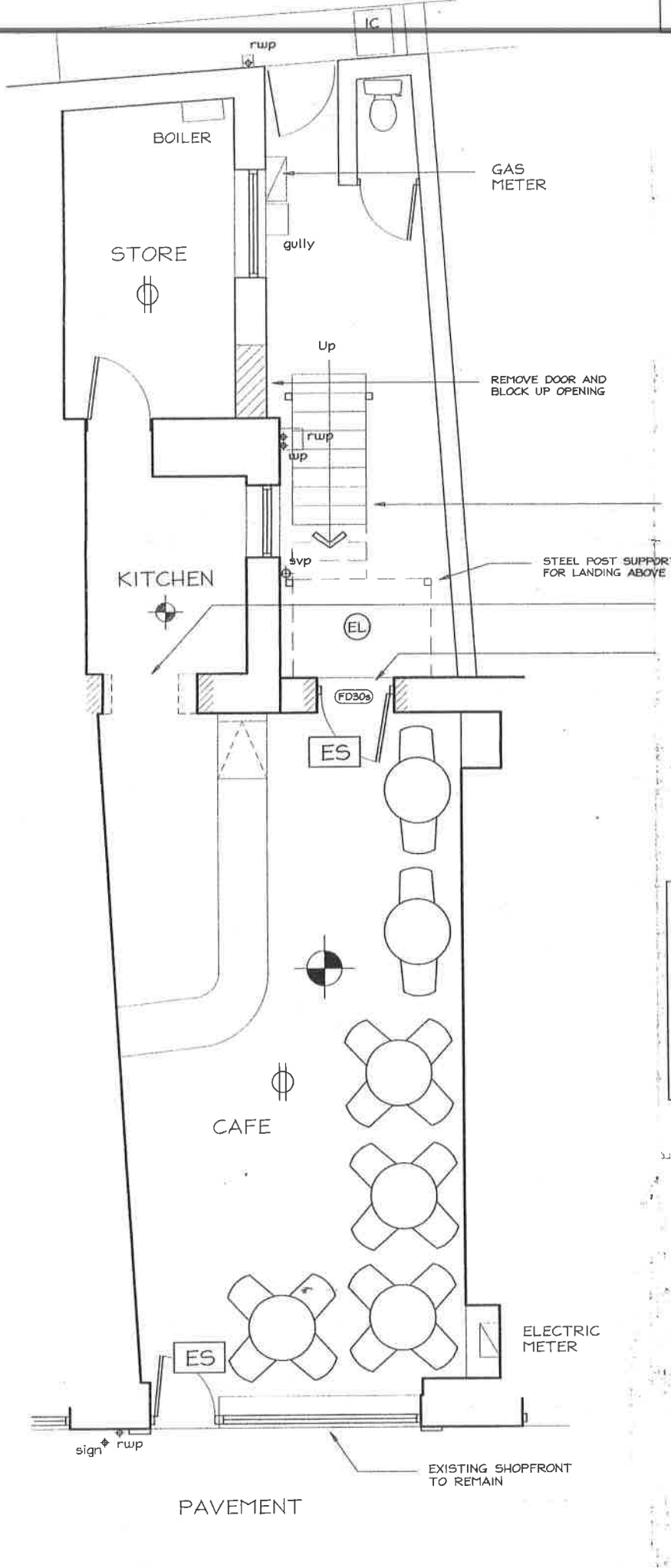

BEAMS & LINTOLS :
 IG OR CATNIC STEEL LINTOLS OVER DOOR AND HI SPANS UP TO 2000mm TO HAVE 2 COURSE LINTOL 3m TO HAVE 3 COURSE LINTOLS OVER. MIN. 150mm

MINIMUM 1/20th ROOM FLOOR AREA OF NEW WINDO NIGHT VENT TO PROVIDE PERMANENT TRICKLE VE SCREENS TO ALL HABITABLE ROOMS, OTHERWISE AND TRICKLE VENTS TO BE AT LEAST 1.75m ABO DOUBLE GLAZED WITH SEALED UNITS TO BS, 5713 SOFT LOW-E COATING TO GIVE MIN. 1.6 U VALUE.

ESCAPE WINDOW TO HABITABLE ROOMS TO HAVE 0.33sq.m. WITH MIN. DIMENSION OF 450mm WIDE/ MIN. 800mm, MAX. 1100mm TO BOTTOM OF OPENIN

ANY NEW DOORS WITH MORE THAN 50% OF THEIR ACHIEVE A MIN. 1.6 U VALUE. ALL OTHER DOORS PROVIDE THERMAL CLOSERS TO ALL REVEALS, LI TO BE INSULATED TYPE.

ANY GLAZING BELOW 800mm ABOVE FLOOR LEVEL GLAZING TO DOORS & SIDE PANELS UP TO A HEIG TO BE SAFETY GLASS AS BS 6206: 1981.

Note: PROVIDE 1 PER 4 LIGHT FITTINGS TO EXTEN HAVING A LUMINOUS EFFICIENCY GREATER THAN 4 DWELLING - POSITIONS TO BE AGREED ON SITE, C LEAFLET GIL 20 IF REQUIRED, TO DETERMINE SUIT LIGHTING.

ALL EXTERNAL LIGHTING TO HAVE LAMPS WHICH I WATTS AND SWITCH OFF WHEN THERE IS ENOUGH AT NIGHT.

NEW STEEL STAIRCASE PAINTED BLACK TO HAVE 225mm GOINGS (EXACT RISE TO BE DETERMINED CONTINUOUS HANDRAIL 900mm ABOVE PITCH LINE STAIRCASES. FIX BALUSTRADE TO LANDING MIN. 1 RAILS.

REMOVE EX. DOOR & CASING & WIDEN OPENING AS OVER AS REQUIRED.

REMOVE EX. WINDOW & BREAK OUT WALL BELOW T SHOWN. INCLUDE DPCs. FIT NEW DOOR & CASING T PROVIDE STONE STEPS AS SHOWN ON DPC.

REMOVE EXISTING STAIRCASE, CART AWAY RUBBL WITH TIMBER FLOOR JOISTS @ 400mm C/Cs.

KITCHEN WALL & BASE UNITS TO BE AGREED SIN TRAPPED WASTE (75mm DEEP) TO CONNECT TO I

FIT FIRE RATED DAMPERS TO EXTRACT FANS / DUCTS

SEPARATING FLOOR CONSTRUCTION :
 EXISTING FLOOR CONSTRUCTION TO BE UPGRAD REGULATIONS
 REMOVE EXISTING LATH & PLASTER CEILINGS & WOOL BETWEEN EXISTING FLOOR JOISTS. FIX SF OF FLOOR JOISTS AT MAX. 300mm CENTRES, F BEAD OF ACOUSTIC SEALANT TO PERIMETER & RATED PLASTERBOARD TO ACHIEVE OVERALL T
 REFER TO MANUFACTURERS INSTRUCTION FOR I
 NOTE : SEPARATING FLOOR WILL REQUIRE PRE-ACCREDITED ACOUSTIC ENGINEER TO ACHIEVE MI AIRBOURNE MIN. 43db, IMPACT SOUND MAX. 62d

NEW 1/2hr PARTITION TO BE FORMED USING 75x50 WITH 13mm PLASTERBOARD (min. 10kg/m²) & SKII CASINGS, ARCHITRAVES & SKIRTING BOARDS ACCOF PARTITIONS SEPARATING BEDROOMS OR ROOMS C ROOM TO BE FILLED WITH MIN. 50mm ROCKWOOL COMPLY WITH PART E BUILDING REGS.

ALL GAPS AT PERIMETER OF WALL, FLOOR & CEIL SMALL AIRPATHS TO BE FILLED WITH NULLIFIRE & SEAL WITH HIGH TEMPERATURE SLIP ADHESIVE IN INSTALLATION & INSTRUCTIONS TO ACT AS FIRE & ISOLATION.

ANY SERVICES, DRAINPIPES ETC., PASSING THROL FLOORS TO BE FILLED WITH NON-COMBUSTIBLE 91 STEEL) SLEEVE TO BE FIRE STOPPED AT PASSAG NULLIFIRE SYSTEM B FIRESTOP COMPOUND. NOTE: SLEEVE TO EXTEND MIN. ONE METRE EACH

CLIENTS SHOULD BE AWARE THAT UNDER THE CG MANAGEMENT) REGULATIONS 2015 (CDM2015) THE PROVIDING A CONSTRUCTION PHASE PLAN AND T AND ENSURING THAT THE WORK IS CARRIED OUT SAFETY. IF THE PROJECT WILL LAST LONGER TH DAYS (WITH MORE THAN 20 PEOPLE WORKING AT NOTIFIED TO HSE.

LINE EXISTING EXTERNAL WALLS WITH 62.5mm KIT SKIN TO BE INSTALLED IN ACCORDANCE WITH MA

ground floor plan.