

# ANNUAL REPORT 2018 - 2019

## Together we've achieved a great deal!

In 2018-19 we've continued to make Pendle an even better place to live, work, study and visit. This has only been possible by continuing to work in partnership with many local organisations.



**Our work has continued behind the scenes on the £32m transformation of our flagship project Northlight into a new learning, living, working, leisure and cultural destination for the North West.**

And we've made strides to expand our employment site, Lomeshaye Industrial estate.

These two projects, along with moves for greater road and rail connectivity, will have a huge impact on Pendle, boosting our economy and creating hundreds of jobs.

We're finding dynamic new ways to protect local facilities by working with some great organisations in our community. And we're focused on providing frontline services in new ways to protect services which matter to local people.

During the past 12 months our staff have continued to work hard to deliver good quality services to more than 90,000 residents.

This Annual Report highlights some of our successes during 2018/19. Pendle has a lot to be proud of and we will build on these successes in 2019/20.



**Strong Services**

**Strong Economy**

**Strong Communities**

**Strong Organisation**

## Things we've done in 2018-19



### Strong Services

In our drive to maintain services whilst being more cost-effective we changed our **recycling collections** in April. Cardboard and paper is now collected every four weeks instead of every fortnight and residents are given the option of a free blue wheelie bin to store their recycling. This change saves us £90k every year. Meanwhile, we continue to offer our popular garden waste collection service to our gardeners. In 2017 from almost 8,000 subscribers we collected around 2,700 tonnes of garden waste which was recycled into compost.

As we move more of our **services online** to keep up with how customers want to contact us, we need to make sure our **website is easy to use**. We were delighted that in June it was hailed as one of the best in East Lancashire according to independent watchdog the Society of IT Managers. Our customers can now access their Council Tax accounts online, apply for benefits, book services and report issues on our website. Anyone who wants or needs support accessing our online services is supported by our customer services team at Number One Market Street in Nelson where there are computers that can be used or free WiFi if use of your smartphone or tablet is preferred.

In July we learnt that eight out of eight of our **Green Flag parks** kept their prestigious status. This means we meet the highest standards demanded by Keep Britain Tidy's Green Flag award scheme and is a great tribute to the hard work of our staff and volunteers.

Our residents regularly tell us that they want us to do more to tackle **litter and dog fouling** so we took on a team of district enforcement officers. The team can give on the spot fines for anyone who is seen to bring parts of Pendle down by not clearing up after themselves. In November our Dog Warden team was awarded a Platinum Stray Dogs Footprint in recognition of 10 continuous years as Gold Pawprint winners. This means our team, which cares for more than 200 stray dogs a year, is one of the best in the UK.

We've also continued to deal with taxi companies which persistently fail **spot checks** to ensure their vehicles are roadworthy and safe for our residents to use.

### Strong Economy

At the heart of what we do is building and maintaining a strong economy. We do this by creating the right environment which will **attract businesses** to locate, grow and stay in Pendle.

Homes at the new Foxhills development next to our historic mill, Northlight, were snapped up and work started to transform the former Oak Mill in Colne into a new housing development called Langroyd Place. Work is ongoing to create attractive family homes at Carry Lane which sit on the edge of open countryside. These developments are led by PEARL a pioneering joint venture company between the Council and local developers and investors Barnfield Construction. Meanwhile work has continued on the transformation of a new £32m learning, living, working, leisure and cultural destination for the North West at Northlight.

Colne businesses voted to become a **Business Improvement District** which means they can raise their own funds to strengthen the town's economy by establishing it as a great place to shop, socialise and do business.

We continued to support our businesses and held our biennial **Pendle Business Awards** at the historic Fence Gate Inn

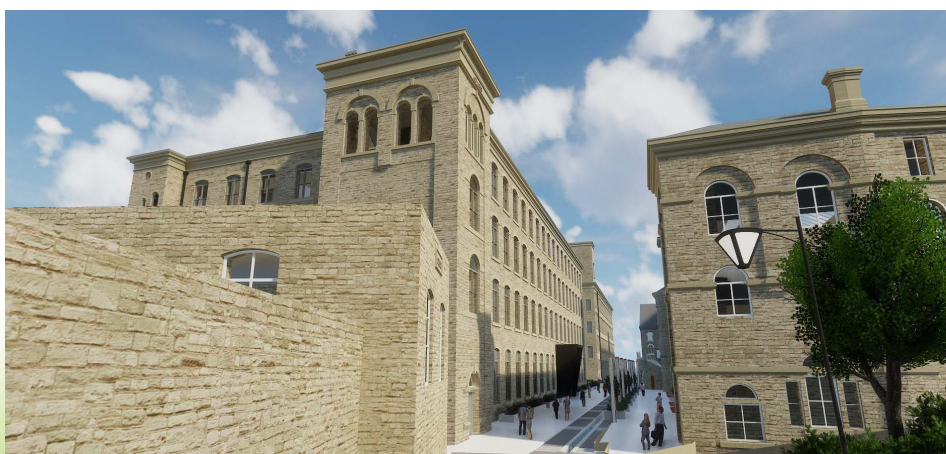



in July. The black-tie event organised by the Council and Pendle Vision Board was hosted by BBC North West Tonight's Beccy Barr. And in October we held our annual **Pendle Business Week** which brings together a wide range of business specialists for new and existing businesses to boost their skills.

Our plans to expand **Lomeshaye Industrial Estate** were given the go ahead from the Government's Planning Inspector in February. Lomeshaye sits alongside the M65 near junction 12 and is one of East Lancashire's largest employment sites and part of a new strategic corridor for economic growth.

We're working for better east-west **road and rail connections** to improve our connectivity into Lancashire and Yorkshire in a bid to boost our economy. We fed in a detailed response on Transport for the North's Draft Strategic Transport Plan encouraging the creation of the A56 Village Bypass as well as the reinstatement of the railway line from Colne to Skipton.

### Strong Communities

Our **Life in Pendle** survey asked residents about what it's like to live in their area so that we could identify how to make Pendle a better place to live. And we urged people of all ages from fitness fanatics to couch potatoes to give their views on **sport and leisure across** Pendle and beyond so that we can provide the right kind of opportunities for people young and old.

We were thrilled when Pendle's double Olympic gold medallist Steven Burke OBE

officially opened the new state of the art 400m **BMX pump track** for people of all ages, further enhancing our cycling offer.

Trawden residents were given the chance to vote on whether to adopt the Trawden Forest **Neighbourhood Plan** in a referendum in November. It was given the thumbs up and was the first to be adopted in Pendle. Any developments in the area have to meet the requirements set out in the Plan. Meanwhile Barrowford has also been creating a Neighbourhood Plan.

A free guide to local services to show what support is available was created for people living with dementia in Pendle and a free legal and financial advice leaflet was launched by Pendle's Dementia Action Alliance.

Pendle is part of the Pennine Community Safety Partnership and we've retained our own **community safety** partnership for Pendle to make sure we can continue to tackle local issues. In 2018/19 we focused on vulnerable people, substance misuse, road safety and community engagement.

Improving **educational attainment** and raising the aspirations of children and young people remained a top priority for us. Through The Pendle Challenge local students and pupils have continued to take part in exciting projects thanks to a collaboration between us and local organisations including nurseries, schools, Nelson and Colne College, Lancashire Adult Learning and local businesses.

Meanwhile, unclaimed grants made available to residents and businesses affected by the devastating flooding in December 2015, were ploughed into flood alleviation measures in Earby.

### Strong Organisation

In November 2018 councillors decided that we should take part in a **Voter ID pilot** along with 10 other councils across England. The pilot tackles local concerns about postal and proxy voting as well as test the government's proposed requirement of showing photo ID when voting in person.



We consulted on whether all councillors should come up for **election** at the same time every four years rather than by thirds. The vote didn't achieve the majority required by law to make the change.

To balance our books we needed to continue to **make savings**. We identified we could do this by moving staff from Elliott House into Nelson Town Hall so that we could close that building.

Our accounts were once again given a **clean bill of health** by independent watchdog Grant Thornton. Summing up our accounts it found that we had a good track record of managing our budget and identifying ways we can save money.

We've signed the **White Ribbon** never to commit, excuse or remain silent about male violence against women. And we've been working with local sports clubs and other organisations to promote the campaign and encourage others to sign the pledge.

## Things we're doing in 2019/20

At the May elections for borough, parish and councillors, we trialled the need to show **photo ID** at all of our polling stations. Anyone without a valid form of ID such as a passport or driving licence, could apply for a Local Electoral Card. We also put measures in place to tackle potential postal vote fraud.

Lancashire County Council has made some changes to its **recycling plant** which means that we can now collect additional plastic items including yoghurt pots, food tubs and trays to increase the amount we recycle.

Demolition work started in September to create a new future for **Colne's former Health Centre** on Market Street. The



exciting project, led by PEARL, will see the creation of a three storey building with six modern apartments for older people on two floors and shops on the ground floor.

We were delighted to learn that Nelson was chosen as one of 100 towns across England which are eligible for up to £25m funding from the **New Town Deal** to boost the town's economic growth. In addition, we've successfully got through the first stage of funding from the government's **Future High Streets Fund** which will be used to boost economic growth in Pendle.

And a partnership between PEARL Together and Liberata Architects has been granted planning permission for up to 200 houses at **Further Clough Head** in Nelson. At least 20% of the homes will be affordable housing to help us address some housing challenges for local people who might not otherwise be able to afford housing.

Councillors declared a **climate emergency** in a bid to tackle the environmental crisis affecting us locally, nationally and globally. A special group has been set up to create an action plan which will make a real



difference.

In our bid to encourage people to take simple steps so that we can all breathe cleaner air, we supported the efforts of Clean Air Day 2019. Staff and residents were encouraged to make pledges to reduce the impact of air pollution.

A new online portal for landlords has been launched which means that any Pendle landlord who has Housing Benefit paid directly to them can log on to the Landlords' Portal 24 hours a day, seven days a week to access payment details.

We were joined by novelist Tracy Chevalier, author of worldwide bestseller Girl with a Pearl Earring, when she climbed Pendle Hill to explore the area's Quaker connections.



A partnership between PEARL Together and Liberata Architects has been granted planning permission for up to 200 houses at Further Clough Head in Nelson.

### What goes where – how 2018/19 Council Tax is split

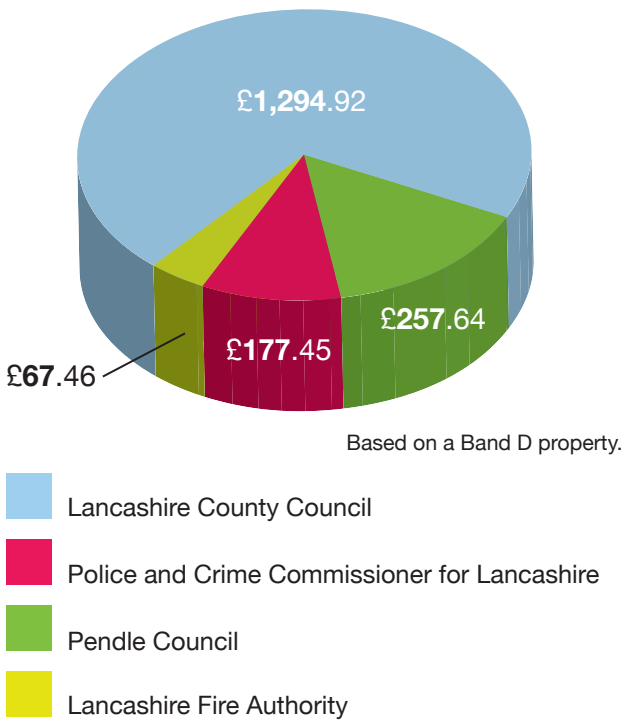

Here's a summary of our income and expenditure for the last financial year, compared with the previous year.

### Council Tax

In 2018/19, the average Council Tax bill, before any charges for Town and Paris Councils, was £1,797.47

Included within this amount is a charge for Pendle Borough Council services of £257.64. This increased by £7.48 compared with the charge for the previous year.

The chart (shown left) provides a comparison of the different charges made for an average (Band D) household.

### Our revenue income

To pay for the cost of providing services to you, we received total net revenue income of £14.3m compared to £14.6m in 2017/18.

Most of our income comes from central government grants and a third comes from council tax charges.

Government Grant	£m	
	£5.8m	2017/18
	£5.5m	2018/19
<b>Council Tax</b>		
	£5.8m	2017/18
	£6.1m	2018/19
<b>Other Net Income</b>		
	£2.2m	2017/18
	£1.9m	2018/19
<b>Use of Reserves</b>		
	£0.8m	2017/18
	£0.8m	2018/19
<b>Total 2017/18</b>		<b>£14.6m</b>
<b>Total 2018/19</b>		<b>£14.3m</b>

## Our revenue spending

We spend money on the delivery of a range of services. The charts below compare our net spending on these services for 2018/19 to net spending in 2017/18.

Directorate	£m
2017/18	0.018
2018/19	0.051
<b>Financial Services</b>	
2017/18	5.995
2018/19	5.766
<b>Democratic and Legal</b>	
2017/18	1.007
2018/19	1.062
<b>Planning, Building Control &amp; Licensing</b>	
2017/18	0.524
2018/19	0.500
<b>Environmental Services</b>	
2017/18	3.547
2018/19	4.574
<b>Housing, Health &amp; Economic Development</b>	
2017/18	1.792
2018/19	1.906
<b>Neighbourhood Services</b>	
2017/18	1.874
2018/19	1.433
<b>Totals</b>	
2017/18	14.757
2018/19	15.292

If you want to read more about the Council's finances, our Statement of Accounts is available by visiting our website [www.pendle.gov.uk/council-finances](http://www.pendle.gov.uk/council-finances)

## Alternatively, you can contact:

**Susan Guinness**  
**Chief Financial Officer**  
**Pendle Borough Council**  
**Town Hall,**  
**Market Street**  
**Nelson**  
**BB9 7LG.**  
**T: 01282 661867**  
**E: [susan.guinness@pendle.gov.uk](mailto:susan.guinness@pendle.gov.uk)**

## Our services financial performance for 2018/19

At the beginning of each financial year, we set a budget (net of fees and charges) for each of our services. This is what we expect to spend during the year. The table below shows how each service has performed against their budget. Overall, we underspent by £160,000.

	Approved Budget 2018/19 £m	Actual 2018/19 £m	Variance 2018/19 £m
Directorate	0.053	0.051	(0.002)
Financial Services	5.716	5.766	0.050
Democratic and Legal	1.097	1.062	(0.035)
Planning, Building Control & Licensing	0.531	0.500	(0.031)
Environmental Services	4.500	4.574	0.074
Housing, Health & Economic Development	1.891	1.906	0.015
Neighbourhood Services	1.495	1.433	(0.062)
Net cost of services	15.283	15.292	0.009
Other corporate income and expenditure variations			(0.169)
<b>Net underspend in 2018/19</b>			<b>(0.160)</b>

## Capital Breakdown

Amount Spent in 2018/19 was **£2.712m**

Amount Spent in 2017/18 was **£9.224m**

	£m
Private Sector Housing	0.754
Environmental, Roads, Street Lighting and Road Safety	0.189
Waste Collection	0.261
General Capital Schemes	0.334
Community Safety	0.014
Area Committees	0.149
Resource Procurement Schemes	0.639
Asset Renewal	0.372
<b>Total</b>	<b>2.712</b>